



## Inline Centrifugal fans AM-AC Series



### APPLICATION

Circular Inline fans are extensively used for supply and exhaust ventilation systems of commercial, office and other premises. The AM-AC fan can cope with high pressure and long duct runs. These fans are compatible with Ø100 up to 315 mm round air ducts.

### DESIGN

- Fan & motor assembly encased in powder coated galvanized sheet steel housing.
- The fans are equipped with external terminal box.
- Fan speed can be controlled by voltage/frequency variation

### MOTOR

- The motor has built-in automatic reset thermal protector.
- The motor is external rotor motor, with compact structure, small size, stable performance and for 50,000 hours working life.

- Fan blade adopts advanced aerodynamic design concept for high efficiency and low noise.
- The fan is balanced on both sides, with low vibration, balance precision level is G2.5.

### SPEED CONTROL

- Smooth speed control with an external thyristor controller or step speed control with an external auto transformer (both available upon separate order).

### MOUNTING

- Due to compact design the fan is the ideal solution for mounting in limited spaces.
- Any mounting position (horizontal/vertical).
- Unique wall or ceiling mounted fixing brackets supplied as a standard
- Flexible air ducts are fixed on fan spigots with clamps.

### DIMENSIONS

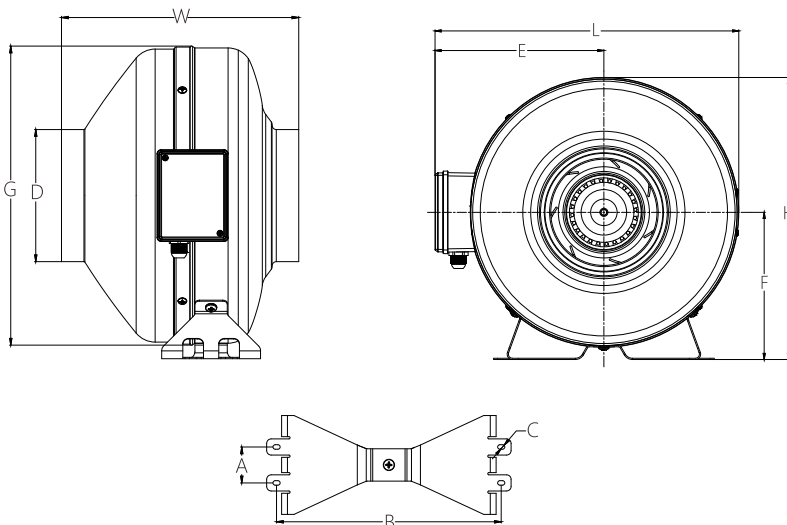

MODEL AM-AC	A	B	ØC	ØD	E	F	ØG	L	W	H
100 K	36	166	5	97	163.5	136.5	244	285	208	258
125 K	36	166	5	123	163.5	136.5	244	285	198	258
150 K	40	250	5	147	208.5	181.5	333	375	264	348
200 K	40	250	5	197	208.5	181.5	333	375	242	348
250 K	40	250	5	247	208.5	181.5	333	375	217	348
315 K	50	270	5	313	243	215	403	444	253	416

## SPECIFICATIONS

MODEL AM-AC	Voltage [V]	Power [W]	Current [A]	dBA	Air Pressure [Pa]	RPM	Weight [Kgs]	
100 K	220~240	51	0.24	44	300	2700	3.1	IP 44
125 K	220~240	73	0.35	45	368	2560	3.2	IP 44
150 K	220~240	110	0.58	47	446	2450	4.3	IP 44
200 K	220~240	175	0.75	59	674	2420	5.2	IP 44
250 K	220~240	175	0.80	59	654	2420	5.1	IP 44
315 K	220~240	225	1.28	65	738	2520	6.6	IP 44

